

TECHNICAL SPECIFICATION

System Type: 2.4 GHz wireless transmitter/receiver

Camera (including antenna) Art. No. 1100
 Operating frequency 2400 – 2483.5 MHz
 Sensor Color CMOS
 Resolution 720p
 Maximum output power 22 dBm
 Transmission distance 100 m
 Operation temperature – 20°C to + 70°C
 IP classification camera IP69K
 Minimum illumination 0.1 Lux
 Night vision range 10 m
 Angle of view 110°
 Power supply 12 V – 32 VDC
 Power consumption 2 W
 Size (W x H x D) 10 cm x 8 cm x 9 cm
 Weight 397 g

Monitor (including antenna) Art. No. 1102
 Operating frequency 2400 – 2483.5 MHz
 Screen type 5" IPS digital panel
 Transmission distance up to 100 m
 Latency 100 ms
 Frame rate 30f/s
 Operation temperature – 20°C to + 70°C
 Brightness 500 cd/m²
 Resolution 1280 x 720
 Power supply 9V–30 VDC
 Power consumption 3 W
 Size (W x H x D) 13.6 cm x 8 cm x 1.1 cm
 Weight 110 g



LUDAFARM

www.Luda.Farm, Krokslätts fabriker 30, 43137 Mölndal, Sweden

LudaFarm_QIG_TrailerCam HD_2020_04_08

EXTRA CAMERA

Available through your local dealer

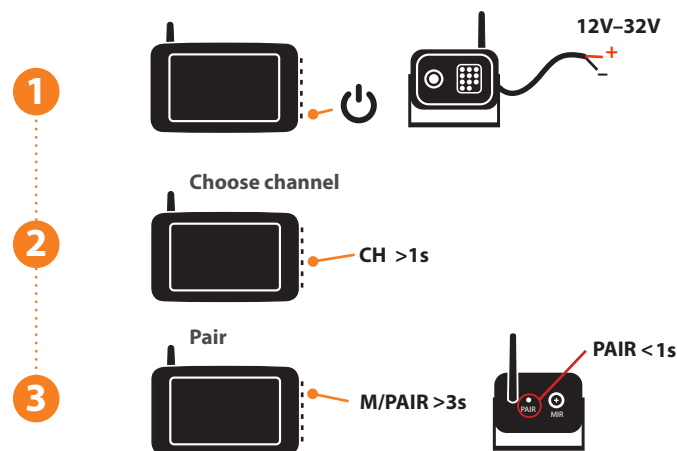

POWER BANK ACCESSORY

Available through your local dealer

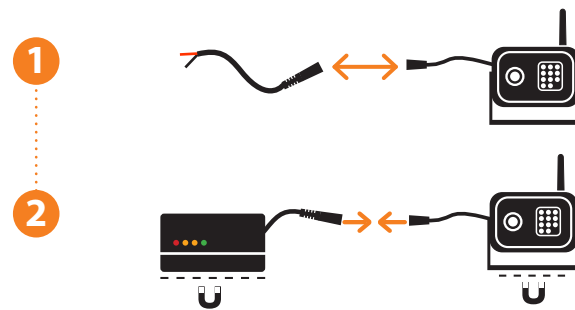

FAQ

- Is the signal between the camera and the monitor encrypted?**
Yes.
- How many cameras can connect to the monitor?**
2 cameras.
- Why does the frame rate sometimes drop when I am driving?**
This can occur when camera and monitor are positioned in a bad angle towards each other.
- Is the camera water resistant?**
The camera and battery are IP69K classed. This means that the camera and battery are well protected from both dust and humidity. It can be placed outside and can be cleaned with water.
- Does the camera have a microphone?**
No.
- I am using the camera for reversing, how do I mirror the image?**
Please see the instructions in the "Operation" section.
- What do I do if the monitor has bad signal reception?**
Move the camera or monitor to a better position, if that does not help, please visit www.support.luda.farm for help/support.
- How does the camera react to minus degrees?**
At very low temperatures the picture might tone into red. At extremely low temperatures the camera might turn off. However, when the temperature gets higher again the camera will regain its functionality.
- The frame rate is low.**
Try to move the camera to see if you can get better signal reception.
- The picture on the monitor is black and white.**
In dark conditions, the IR LEDs will automatically switch on, resulting in pale colors. With very limited lighting, the picture will become completely black & white.

trailerCam HD

SAFETY FOR YOU AND YOUR HORSE

QUICK GUIDE



Register your product today to get the 3 year warranty. luda.farm/warranty-register



For more detailed information



→ www.support.luda.farm

ENGLISH

INCLUDED IN THE BOX



Camera

Art. No. 1100



5" Monitor

Art. No. 1102



12V Power Cable

Art. No. 6047



Monitor Holder

Art. No. 7034



Direct Power Cable

Art. No. 6048



Installation Kit

For mounting the camera

INSTALLATION

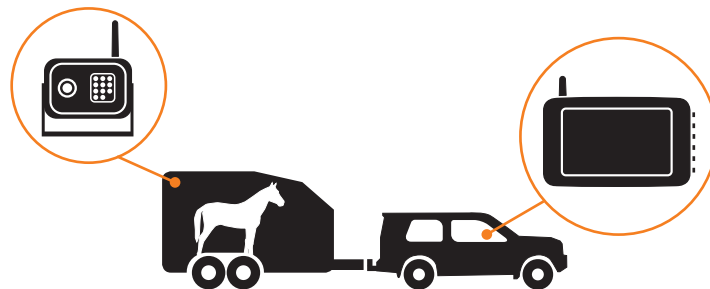

Connect the camera to power in the trailer

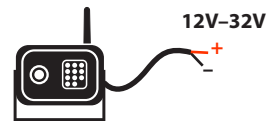

Connect the monitor to power in the vehicle



or



Authorized service center recommended

OPERATION



1 Power the vehicle

2 Turn on the monitor



Channels

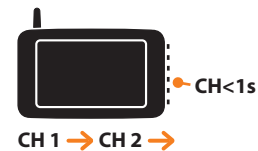

Do not operate while driving

Mirror Mode

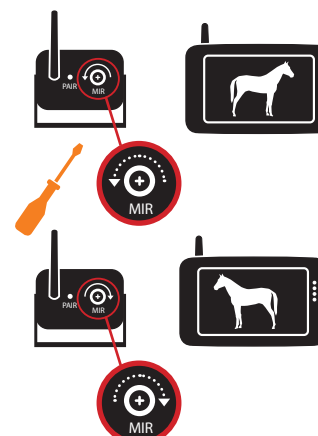

Parking Assistance



TROUBLESHOOTING

